



C20204 2 – 4 GHz 20 dB Directional Coupler

FEATURES

- ❖ Low VSWR
- ❖ High Directivity
- ❖ Low Insertion Loss
- ❖ Small Package



SPECIFICATIONS

2 – 4 GHz 20 dB Directional Coupler	
Model Number	C20204
Frequency Range	2 – 4 GHz
Coupling Value	20 ± 1 dB Max.
Frequency Flatness	±0.60 dB Typ., ±0.75 dB Max.
Insertion Loss (excluding coupled power)	0.20 dB Typ., 0.30 dB Max.
Directivity	26 dB Typ., 22 dB Max.
Main Line Input VSWR	1.10:1 Typ., 1.201 Max.
Main Line Output VSWR	1.10:1 Typ., 1.201 Max.
Input Power Handling	80 W CW Max.
Impedance	50Ω
Connector Type	SMA Female (other options available on request)

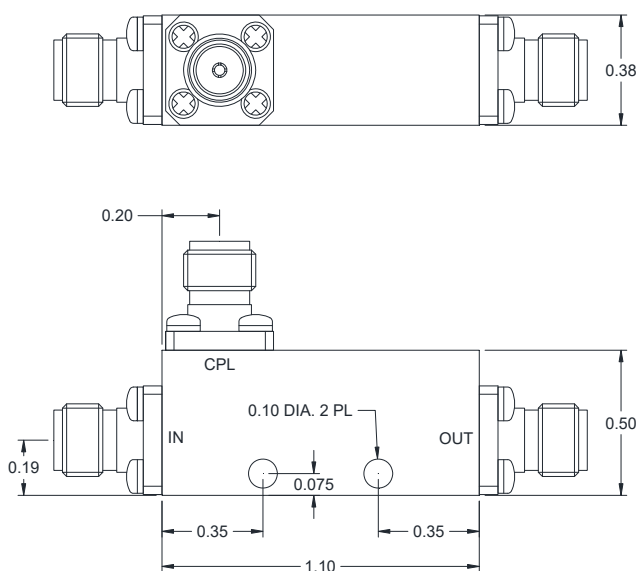

Design to meet the following environmental specifications: (verification optional)

1. Operating Temp: -55°C to +85°C
2. Storage Temp: -65°C to +125°C
3. Shock: MIL-STD-202F, M213, Cond B
4. Altitude: MIL-STD-202F, M105, Cond B
5. Vibration: MIL-STD-202F, M204, Cond B
6. Thermal Shock: MIL-STD-202F, M107, Cond A
7. Temp. Cycle: MIL-STD-202F, M105C, Cond D
8. Humidity: MIL-STD-202F, M103, Cond B
(Optional with Hysol epoxy seal)

Standard Finishing: Rugged Aluminum Housing, optional finishing with blue epoxy paint per MIL-C-22750 available on request.

Note:

1. Coupling refers to the input port
2. Standard connector is SMA female for all the ports
3. Other connector combination is available on request
4. Power handling is under the condition that all the outputs are connected to the loads with 1.25:1 or better VSWR and the unit is mounted with excellent heat sink