



LTK112 10 KHz – 12.4 GHz Limiter

FEATURES

- ❖ Low Insertion Loss
- ❖ Low VSWR
- ❖ Mounting Hole Option
- ❖ Customer Design Available



SPECIFICATIONS

10KHz – 12.4 GHz Limiter	
Model Number	LTK112
Frequency Range	10 KHz – 12.4 GHz
Insertion Loss	0.60 dB Typ., 0.8 dB Max.
Input VSWR	1.20:1 Typ., 1.28:1 Max.
Output VSWR	1.20:1 Typ., 1.28:1 Max.
Peak Input Power	20 Watt Max.
CW Input Power	5 Watt Max.
Peak Flat Leakage	18 dBm Typ., 20 dBm Max.
CW Flat Leakage	16 dBm Typ., 18 dBm Max.
Impedance	50 ohm.
Connector Type	SMA Female (other connector available on request)

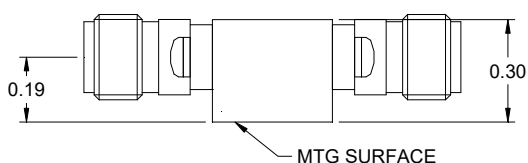
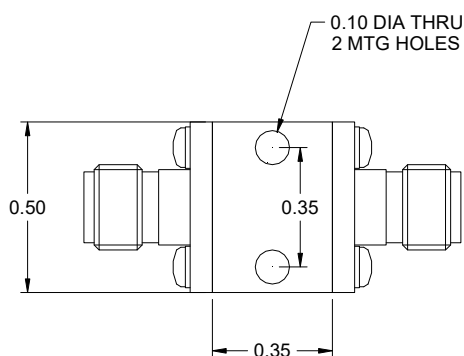

Design to meet the following environmental specifications (verification optional)

1. Operating Temp: -55°C to +85°C
2. Storage Temp: -65°C to +125°C
3. Shock: MIL-STD-202F, M213, Cond B
4. Altitude: MIL-STD-202F, M105, Cond B
5. Vibration: MIL-STD-202F, M204, Cond B
6. Thermal Shock: MIL-STD-202F, M107, Cond A
7. Temp. Cycle: MIL-STD-202F, M105C, Cond D
8. Humidity: MIL-STD-202F, M103, Cond B (Non-standard, optional with Hysol epoxy seal)

Standard Finishing: Rugged aluminum housing, optional finishing with blue epoxy paint per MIL-C-22750 available on request.

Note:

1. Male/female combination available on request
2. Part number for different connector combination is as follow
Add "M" suffix for male to male
Add "MF" suffix for male to female
Performance may change a little bit.
3. Other connector type available on request
4. Flat leakage test is at 2 GHz with 1 W input power.
5. Power handling is linearly derated from full power at 25 °C to zero at +125 °C with excellent heat sink